

Leavenworth County, KS

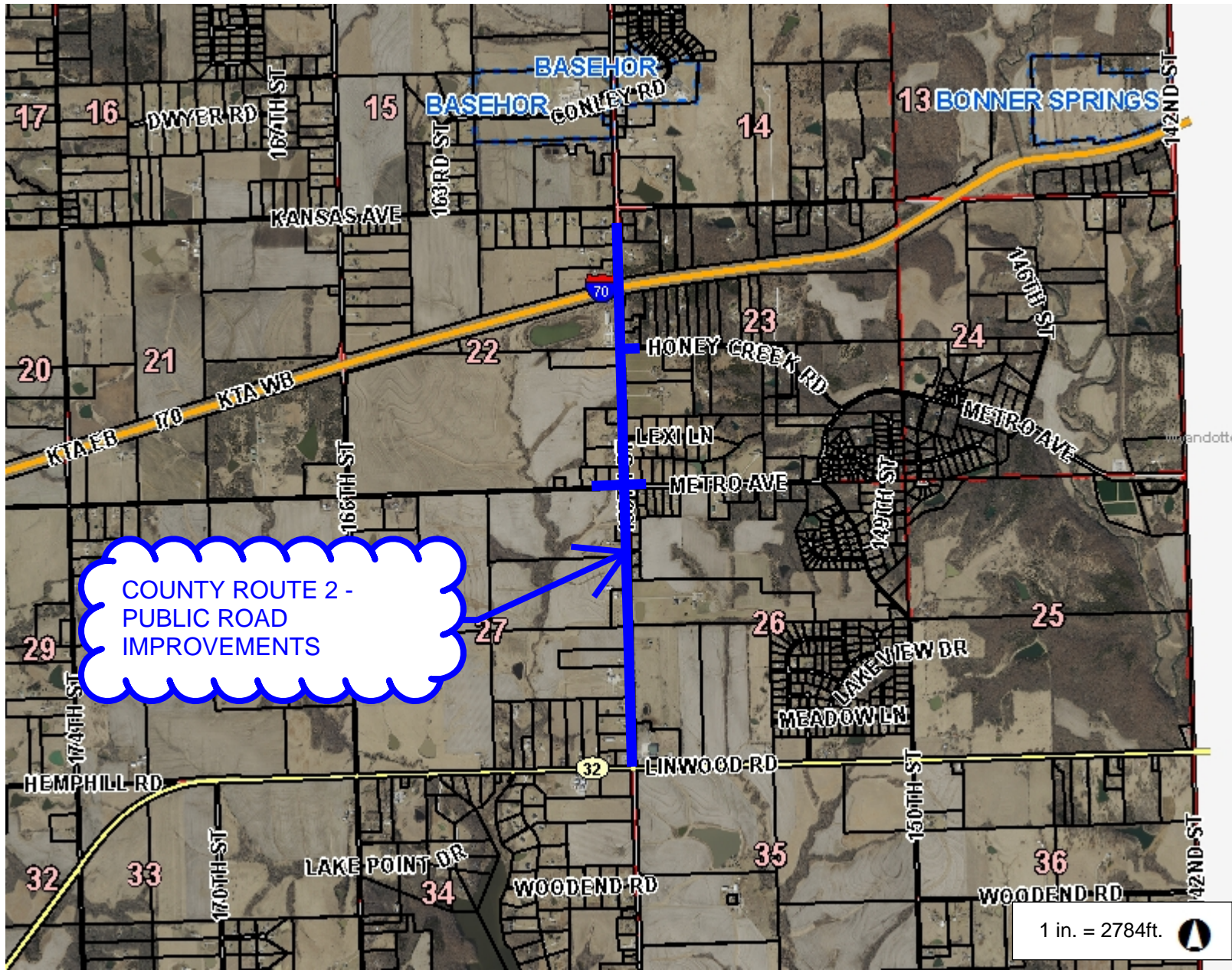

Legend

- Parcel
- City Limit Line
- Major Road
 - <all other values>
 - 70
- Road
- Railroad
- Section
- Section Boundaries
- County Boundary

1 in. = 2784ft.



5,567.2 0 2,783.61 5,567.2 Feet

This Cadastral Map is for informational purposes only. It does not purport to represent a property boundary survey of the parcels shown and shall not be used for conveyances or the establishment of property boundaries.

THIS MAP IS NOT TO BE USED FOR NAVIGATION

Notes